

Bl. 57

556

674

421

447 452

461 466 477 484 485

558

563

406 410 422 425 436/1 439/1 448 451 462

465/1

564

565

570

481/2

483

571

573/1

465/2 479/2

572

Landesstr.

1235

00

408 409 423 424 437 438 449 450 463 305-6 464

479/1 481/1 323 321 320

310 311 312 314 316

322

581

584

-81 250,00

Handwritten mark

Bl. 57

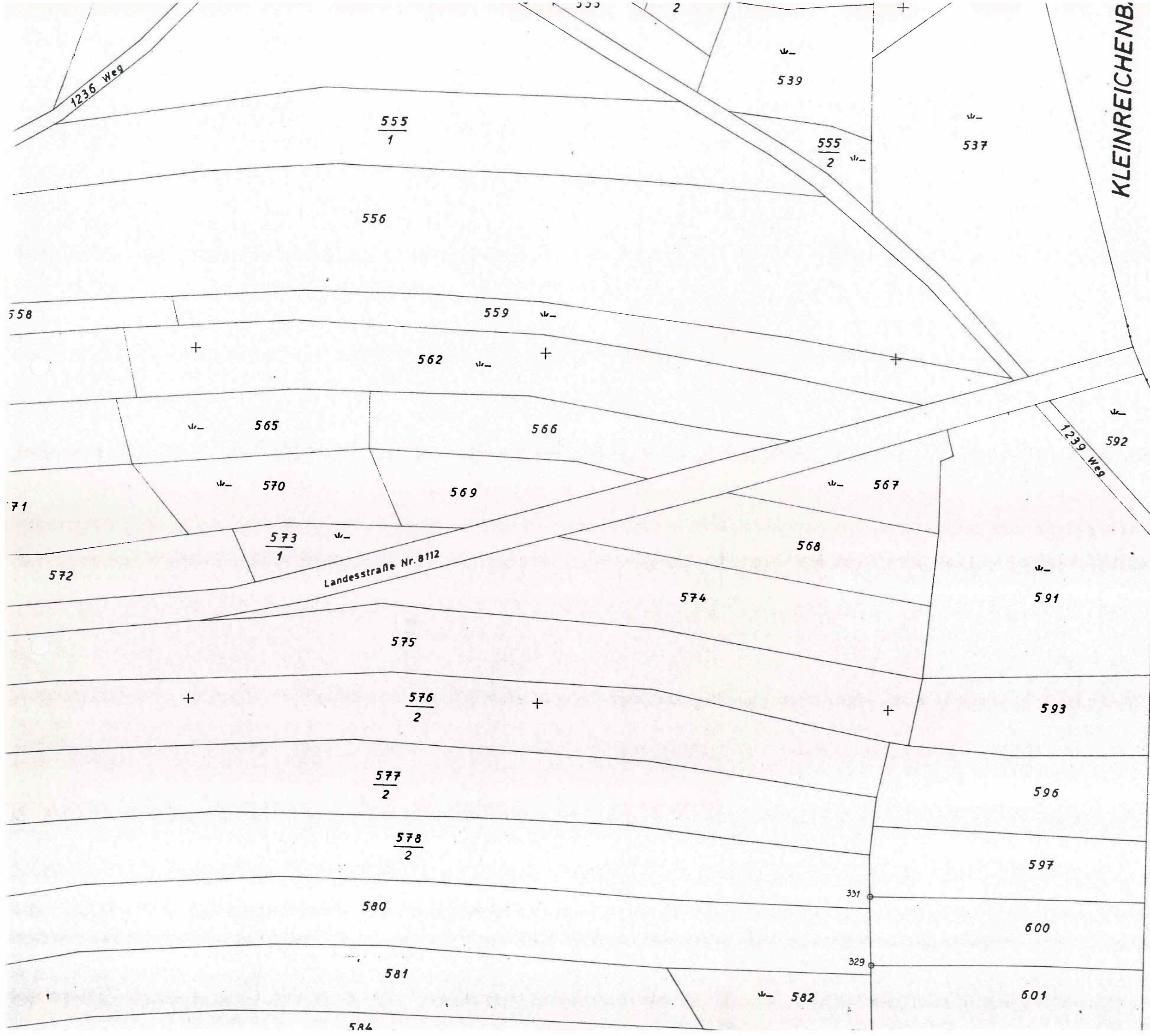

7/79-64/4

Sparbach
21185

Bl. 57

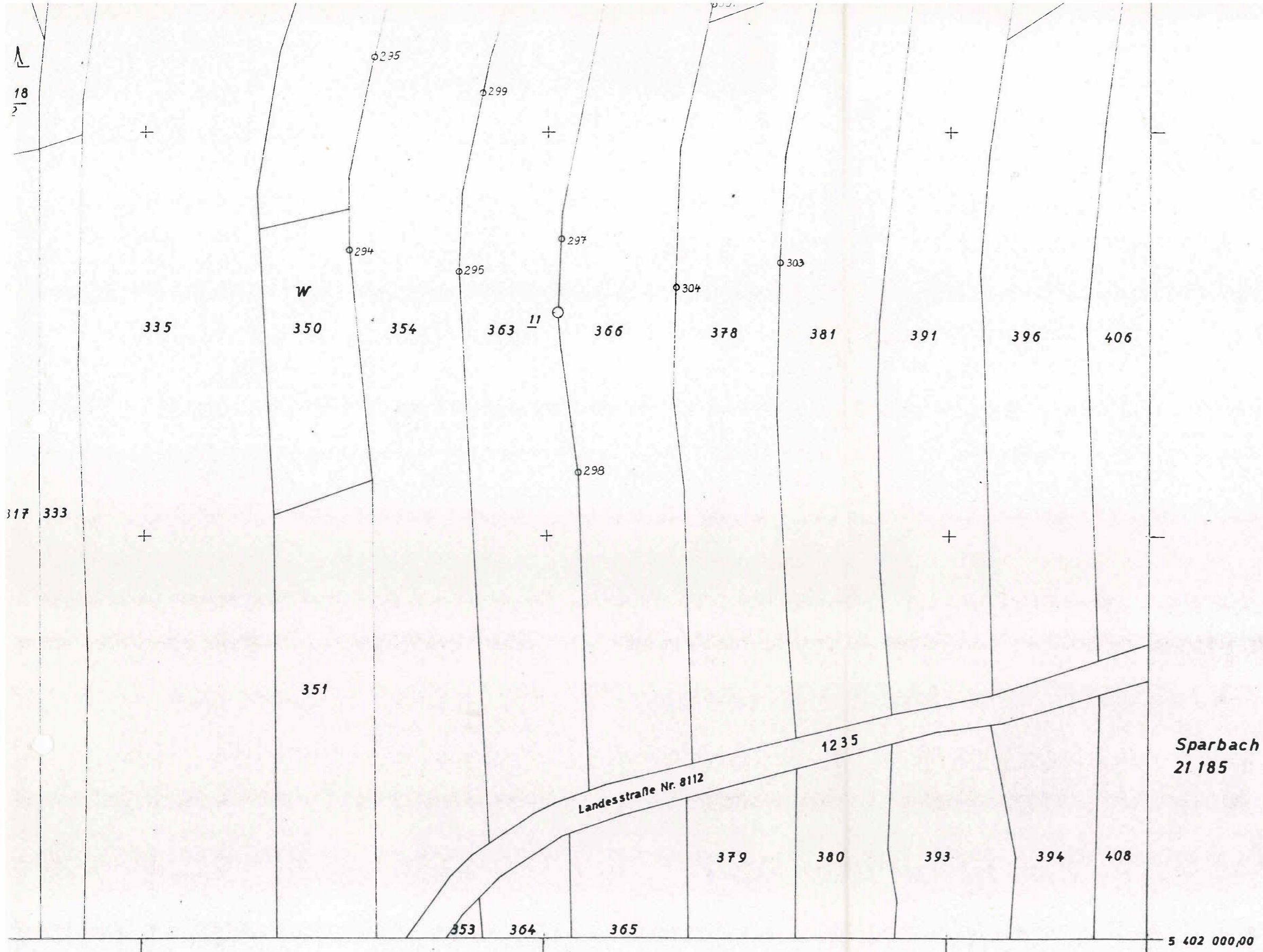

Sparbach
21 185

5 402 000,00

-81 250,00

6741-63/4

